

HÔTEL  
SALOMON DE ROTHSCHILD  

---

PARIS



PARIS SOCIETY  
EVENTS









HÔTEL SALOMON DE ROTHSCHILD  
**PICTURESQUE AND PRESTIGIOUS**

---

*If the history of Paris is full of charm,  
the Hôtel Salomon de Rothschild is its embodiment*

Marked by its Haussmannian architecture, this 19th-century residence is much more than a mere relic of the past - it is a witness to an era when art, culture and society mingled in harmonious ballet. Baroness Adèle, as the former mistress of the house was known, mastered the art of entertaining and delighting her guests. Now listed as *Monuments Historiques*, its walls perpetuate this tradition of excellence and host a multitude of prestigious events.

## HÔTEL SALOMON DE ROTHSCHILD

---

Set in a green setting, this private mansion comprises three hushed, grandiose floors that skilfully combine the architecture of the past with contemporary comfort.

Its vast salons are filled with the murmurs of visitors over the centuries. The majestic fireplaces are the imprint of lively stories and convivial exchanges around the fire. Behind each wood-panelled door, a space is revealed, ideal for upscale receptions of any scale.

---

**TOTAL SURFACES:**

Indoor: 800 m<sup>2</sup>

Outdoor: 4 540 m<sup>2</sup>

**EQUIPMENTS:**

Sound and light system

WIFI





# YOUR EVENT AT THE HÔTEL SALOMON DE ROTHSCHILD



PARIS SOCIETY EVENTS

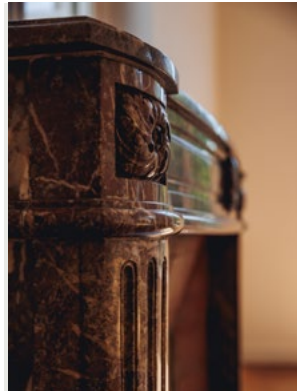
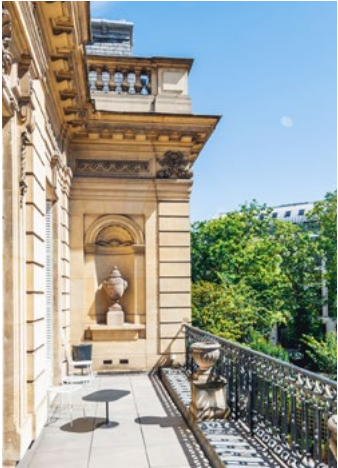

PRESENTATION BOOKLET





*Prestigious event on the*

**1<sup>ST</sup> FLOOR**



1<sup>ST</sup> FLOOR  
**THE ORATORY**

---

Once a place of prayer, this pure room with its delicately emerald-tinted walls is illuminated by the light from outside. With a breathtaking view over the park, it inspires calm and privacy, creating unique moments of encounter.

---

**SURFACE:**95 m<sup>2</sup>**CAPACITIES:**

Cocktail reception: 130 guests

Conference: 90 guests

Seated meal: 70 guests





1<sup>ST</sup> FLOOR  
**THE BILLARDS ROOM**

---

This central living space features elegant, refined architecture. On one side, large wall mirrors embellish the wall, reflecting light and creating elegant perspectives. On the other, picture windows open onto a small terrace with an overhanging view.

---

**SURFACE:**

63 m<sup>2</sup>

**CAPACITIES:**

Cocktail reception: 60 guests

Conference: 40 guests

Seated meal: 50 guests



1<sup>ST</sup> FLOOR

## THE HÉLÈNE BEDROOM

—

The different orientations of the parquet floor are remnants of the organization of the bedroom, anteroom and bathroom of the Baroness's only daughter, Hélène.

Now renovated, this room delicately blends modern equipment with period details, leaving plenty of room for your creativity.

---

**SURFACE:**

117 m<sup>2</sup>

**CAPACITIES:**

Cocktail reception: 150 guests

Conference: 114 guests

Seated meal: 80 guests







*Surprising events in*  
**THE BALLROOM**





BASEMENT

## THE BALLROOM

---

Hidden away in the basement of the Hôtel particulier is a space of unsuspected size and technology. Over 480m<sup>2</sup> are fully equipped to host and adapt to all event formats, from large-scale conferences to the most festive evenings.

---

### **SURFACE:**

486 m<sup>2</sup>

### **CAPACITIES:**

Cocktail reception: 490 guests

Conference: 400 guests

Seated meal: 350 guests

### **EQUIPMENTS:**

Sound and light system

1 stage 8×3m, 6 arches, 1 screen 8×4,5, 2 PC, 2 screens 43"...





*A verdant interlude in*  
**THE GREEN SPACES**



OUTDOOR  
**THE DEER GARDEN**

---

This garden was the last home of Honoré de Balzac, as evidenced by the rotunda erected in his memory by Baroness Adèle.

This expanse of greenery features reliefs, shades, columns and elegant sculptures. It's the ideal setting for garden parties or outdoor dining events.

---

**SURFACE:**

360 m<sup>2</sup>

**CAPACITY:**

200 guests







OUTDOOR  
**THE FOUNDATION PARK**

---

A narrow staircase leads up to the park, revealing a breathtaking view of the entire property.

The expanse of fresh grasses, the tall majestic trees and the delicate breeze caressing the foliage welcome your guests into an elegant and generous setting. In this lush setting, your special events will create lasting memories.

---

**SURFACE:**  
3 900 m<sup>2</sup>

*Subject to prior authorization - Public domain*



*Basement*

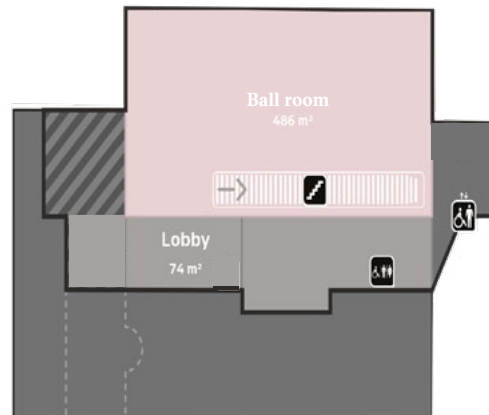

*1st floor*

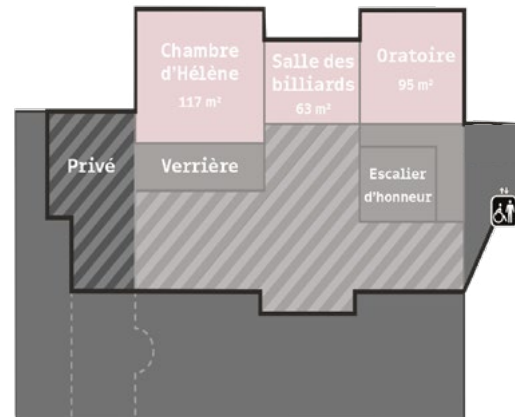

**VENUE PLAN**





## ACCESS

—

### ADDRESS

11, rue Berryer - 75008 Paris

### TRANSPORTS

Metro: Line 1 - Stop George V (6 min on foot)

Lines 1, 2 & 6 - Stop Charles de Gaulle - Étoile (7 min on foot)

Bus : Lines 22, 43, 52, 83 & 93- Stop Friedland - Haussmann  
(6 min on foot)

Velib : Station 8053 - Stop Place Georges Guillaumin (1 min on foot)

### PARKING

Parking Zenpark - 25 Avenue de Friedland (4 min on foot)

### GPS COORDINATES

48.875023, 2.302648





## CONTACT



01 45 26 04 58

[evenements@paris-society.com](mailto:evenements@paris-society.com)



PARIS SOCIETY  
EVENTS



## CONTACT



David Maganinho

06 21 06 81 90

[d.maganinho@paris-society.com](mailto:d.maganinho@paris-society.com)



PARIS SOCIETY  
EVENTS





REZ-DE-CHAUSSÉE

## BARONNE

—

Texte en attente

---

**SUPERFICIE :**

?? m<sup>2</sup>

**CAPACITÉS :**

Cocktail : jusqu'à ?? personnes

Repas assis : jusqu'à ?? personnes

**ÉQUIPEMENTS :**

??